

Product Information

Language	INGLESE
Nr.	255
Date	5/2016
Subject	741



our **power**, your **passion**

NEW 741 PROFESSIONAL BRUSHCUTTER



Mod. 741

The new **741** brushcutter is designed to offer high efficiency and unfaltering quality over time, even in the face of heavy and prolonged use. The new professional 2-stroke engine, aluminium drive shaft (\varnothing 28 mm) with steel shaft (\varnothing 8 mm), 6 flexible bushings, LOAD & GO nylon head, 3 teeth disc cutter. The machine incorporates numerous features and is ideal for tough jobs like cutting thick grass, clearing brushwood, and thinning reed beds. Every detail has been designed with care to render brushcutting duties easy and effortless, even for the inexperienced user, the pluses are:

- High performance, for maximum productivity
- Accuracy of cut, avoiding damage to vegetation around the work area and obtaining best possible results
- Total comfort, with muscle fatigue minimized both when starting the machine and during prolonged use. It allows an ergonomically correct posture for the operator
- Ease of use, allowing even comparative novices to operate the equipment ultra-simply and in complete safety.
- Low fuel consumption and low emissions, for minimal environmental impact
- Easy maintenance for quick machine check-up and intervention.

PERFORMANCE AND ENGINEERING SOLUTIONS

- **New engines** designed to resist heavy duty usage and prolonged.
- **Piston with 2 rings, chrome-plated cylinder**, forged con rod and crankshaft (Fig. 1): guaranteeing an extremely rugged and durable engine.
- **High torque** at all crankshaft speeds: effective cutting and unfailingly steady work rate, even on particularly dense vegetation.
- For a longer working life the machine is fitted with an **magnesium clutch housing** (fig 2a), resists heavy operating conditions, along with the lower support (Fig 2b) to protect against accidental damage.
- **Digital coil with electronic control**: ensures effortless starting and improves performance, always guaranteeing uniform combustion and low fuel consumption.
- **Generously sized cloth air filter**: guarantees high filtration efficiency and easy maintenance (Fig. 3a).
- **Filter support (Emak patent) with anti-backflow element** (Fig. 3b), (prevents the filter from becoming fouled by fuel) for longer operation between filter maintenance procedures.
- **Ø 28 mm aluminium drive tube** (Fig. 4a), with 6 self-lubricating antivibration bearings (Fig. 4b), **8 mm internal rigid shaft** (Fig. 4c) and **aluminium bevel gear pair with M 10 male drive pin** (Fig. 4d), for unimpeded power transmission.

Fig. 1



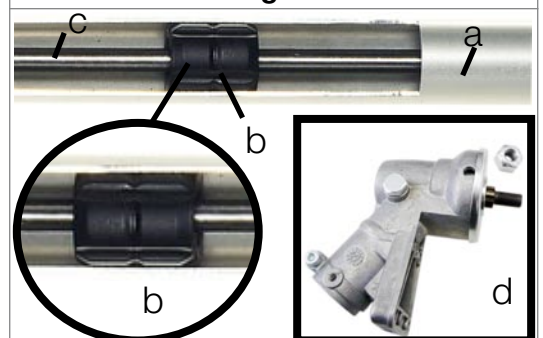
Fig. 2



Fig. 3

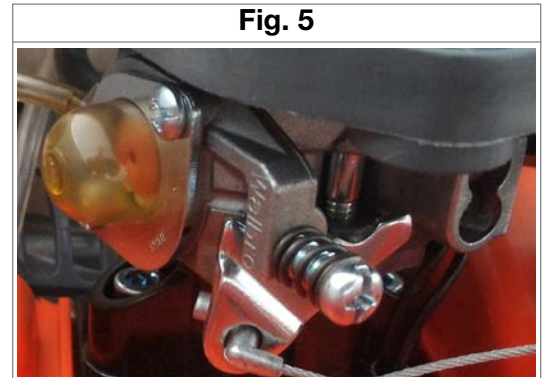


Fig. 4



EASE OF USE

- **Air purge primer** (Fig. 5) visible on the carburetor ensures easier access and operation.
- **Walbro carburetor** ensures specific mix of fuels, with the option to be adjusted to the user's needs (Fig 5).



- **“Easy on” device** (Fig. 6a) composed of a double spring in the starter cover combined with driver with two ratchets means reduced force with each pull and fast starting with fewer rope pulls.
- **Dual grip filler cap** (side and top) and **vertical filler neck** (Fig. 6b) designed for ease of refuelling.





- **Innovative 130 mm Ø “LOAD & GO” line head** (Fig. 7): for straightforward line replacement - just 20 seconds to rewind the line and resume work.
- **Steel disc cutter with 3 teeth** Ø 10” / 255 mm, thickness 1,8 mm



- Several **optional accessories** are available for the various versions (identified by the outer diameter of the shaft arm) to allow different kinds of uses, according to the particular application (Fig. 8).

Fig. 8

		
	EP 100	4188 901
741	O	O

COMFORT

- **Built-in antivibration system:** greatly reduced vibrations felt by the operator during use of the tool (Fig. 9).

- **Ergonomic handle** (Fig. 10): aluminium with moulded rubber grips. The operator always has a firm and comfortable grip on the machine.

- **The on/off switch** (Fig. 10a) returns automatically to the “on” position after each stop (always on).

- **Double harness**, ergonomically contoured: designed to facilitate operations even on slopes and slippery surfaces (Fig 11).

- **Stone guard** is supplied with a shaft clamp (Fig 12a) to offer a more flexible fitting position along the drive shaft (Fig 12b).

Fig. 9

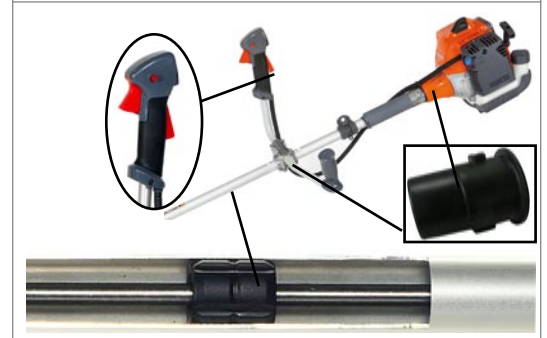


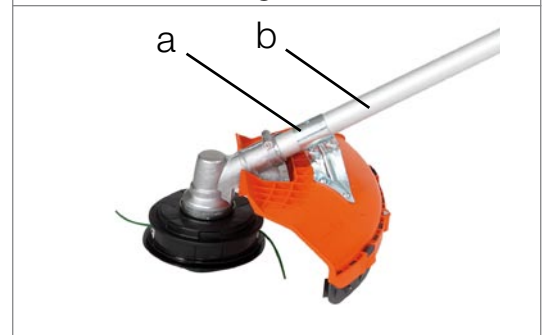
Fig. 10



Fig. 11



Fig. 12



EASE OF MAINTENANCE

- **Generously proportioned paper filter element** (Fig. 13): ensures longer intervals between cleaning operations.

Fig. 13



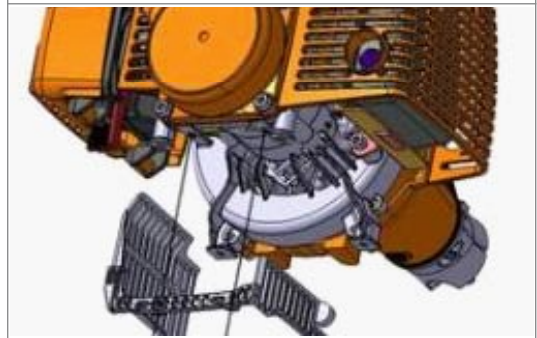
- **Filter cover accessible with tools** by means of specific knob (Fig. 14a): facilitates air filter inspection and cleaning.

Fig. 14



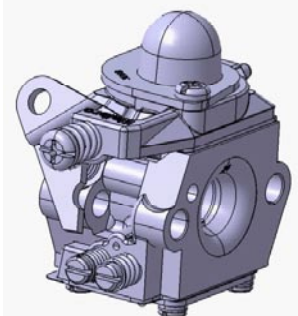
- **A new filtering grid** (Fig 15) has been equipped to keep off grass and dust from the engine ventilation area, together with a new modified crank-case to better ensure an adequate system cooling while running the unit.

Fig. 15



- **Walbro traditional carburetor** (Fig. 16) allows the adjustment of carburetion acting with an ordinary screwdriver on the screws of the minimum and of the maximum.

Fig. 16



TECHNICAL SPECIFICATIONS

MODEL	OM	741
ENGINE		
TYPE		Emak 2-stroke / EXTRA GE
DISPLACEMENT	cm ³	40,2
MAXIMUM POWER OUTPUT	HP/kW (rpm)	2,1 / 1,6 (7500)
MAXIMUM TORQUE	Nm (rpm)	2,08 (5500)
IDLING SPEED	rpm	2800
MAXIMUM NO LOAD SPEED	rpm	11700
HOURLY FUEL CONSUMPTION (at max power output)	g/h (rpm)	750 (7500)
IGNITION SYSTEM		
TYPE		Digital
EASY ON		Yes
FUEL & LUBRICATION SYSTEM		
CARBURETTOR		Walbro
FUEL		Mix 4% with PROSINT oil 2% (50:1)
FUEL TANK CAPACITY	l	0,75
AIR FILTER		Paper
PRIMER		Yes
TRANSMISSION SYSTEM		
DRIVE SHAFT (Ø) "Outer / Inner"	mm	28 (with steel shaft Ø 8mm)
ROD LENGTH	mm	1556
BEVEL GEAR PAIR		with M10 male thread
CLUTCH (DIMENSION)	mm	2 elements with FERODO PADS (75 x 18)
SAFETY		
SOUND PRESSURE (LpA EN ISO 11806 - EN 22868)	dB(A)	disc 98
		nylon head 100
SOUND POWER (LwA 2000/14/EC - EN 22868 - EN ISO 3744)	dB(A)	disc 110
		nylon head 116
VIBRATION LEVEL (EN 11806 - EN 22868 - EN 12096)	m/s ²	disc 5,1 SX - 5,8 DX
		nylon head 3,7 SX - 5,4 DX
ERGONOMICS		
HARNESS		Professional full body harness
HANDLE		ERGONOMIC Handlebar
HANDLE CONTROL		Ergonomic with moulded rubber grips + always on
ANTI-VIBRATION SYSTEM		6 self lubricating brass and rubber bushings in drive shaft.+ 1 rubber in the clutch housing to shaft. + 2 rubber between handlebar and tube
CUTTING SYSTEM		
STANDARD CUTTING DISC		Steel disc cutter with 3 teeth Ø 10" / 255 mm, thickness 1,8 mm
STANDARD NYLON STRINGHEAD		Load & Go Ø 130 mm with Ø 3.0 mm nylon line
CUTTING GUARD - CUTTING WIDTH (with stringhead)	mm	Plastic (380)
WEIGHT (Without cutting tools)	kg	7,9
POWER-TO-WEIGHT RATIO	kg / Kw	4,9



It's an **Emak S.p.A.** trademark Member of the Yama Group
Via E. Fermi, 4 • 42011 Bagnolo in Piano (Reggio Emilia) Italy
Tel. +39 0522 956611 • Fax +39 0522 951555
venditeitalia@oleomac.it • www.oleomac.it

